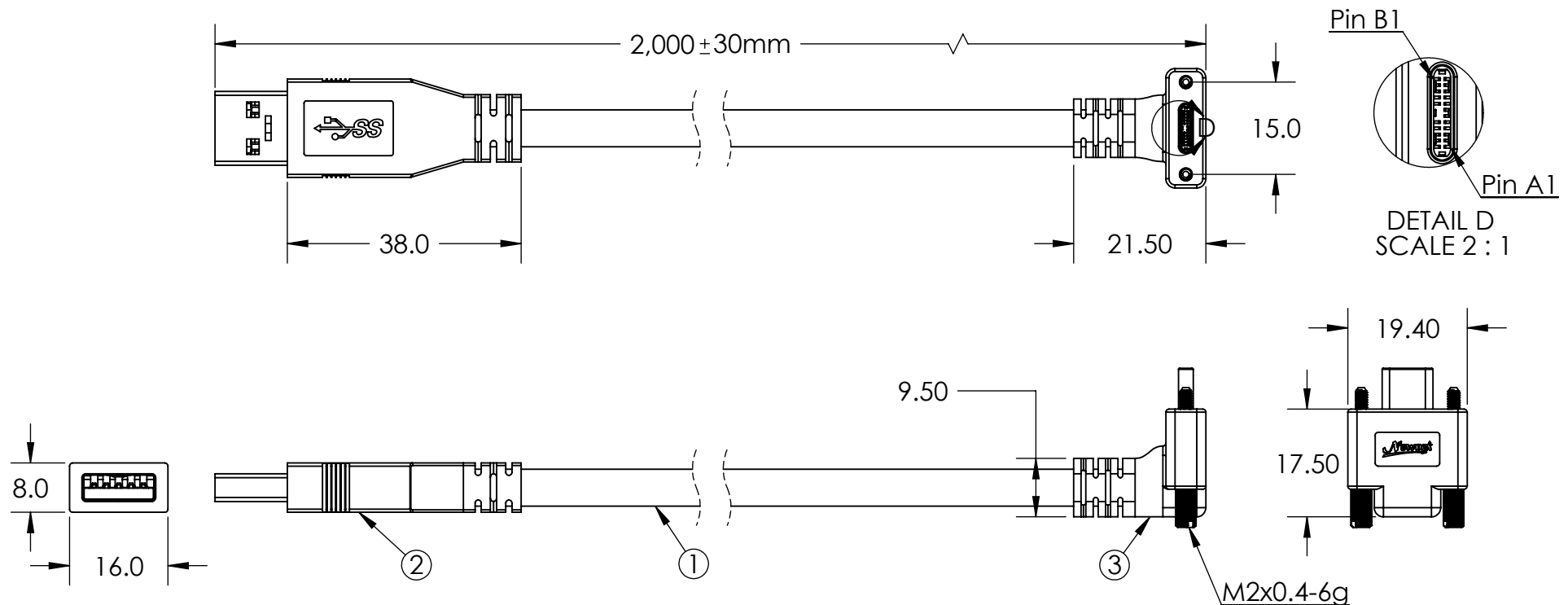

NEWNEX PROPRIETARY

THIS DOCUMENT AND THE DATA DISCLOSED HEREIN OR WITHIN IS NOT TO BE REPRODUCED, USED, OR DISCLOSED IN WHOLE OR PART TO ANYONE WITHOUT THE WRITTEN PERMISSION OF NEWNEX

COMPANY NAME**CUSTOMER SIGNATURE****DATE****COMMENTS:****WIRING STRUCTURE**

A Male	SIGNAL NAME	Type C
1	VBUS	A4,B4,A9,B9
-	CC	A5
2	Dn1	A7
3	Dp1	A6
4	GND	A1,B1,A12,B12 ,SHELL
7	Drain	
SHELL	Braid	
5	SDPn1	A3
6	SDPp1	A2
8	SDPn2	B10
9	SDPp2	B11

Rp=56KΩ

Notes:

1. Cable: USB 3.1 Black PVC Jacket.
2. Connector: USB 3.1 A Male.
3. Connector: USB 3.1 Type-C Down Angled Male Dual-Screw Locking, with 56k Rp.
4. Packaging: 1 Piece + PE bag.

Newnex Technology Corp.



UNLESS OTHERWISE SPECIFIED
DIMENSIONS ARE IN MILLIMETERS
TOLERANCES ARE:

FRACTIONS DECIMALS ANGLES
• NA XX ± 0.5
XX ± 0.25
XXX ± 0.125

PROJ. SCALE: 1:1

REV. A

TITLE: USB 3.1 A Male to C Down Angle Male with Dual-screw Locking, 2M, Black.

DRAWN BY: AC

APPROVED BY: XW

PART NUMBER:

U3S1A01C6D-020

CHECKED BY:

SHEET 1 OF 1

REVISION COMMENTS:

Drawing generated

*100% OPEN, SHORT, MISWIRE TESTING

*RoHS compliant product

*Both shell clam and copper foil have 360 degree contact with braiding