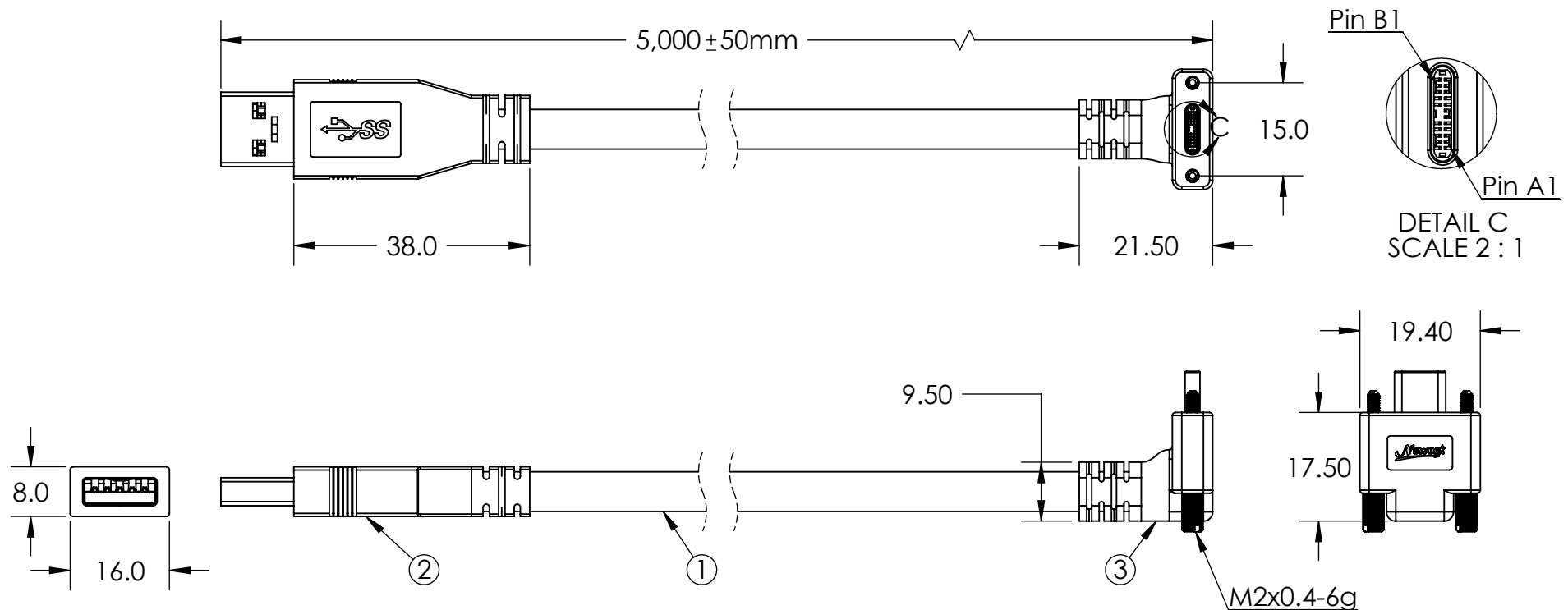

NEWNEX PROPRIETARY

THIS DOCUMENT AND THE DATA DISCLOSED HEREIN OR WITHIN IS NOT TO BE REPRODUCED, USED, OR DISCLOSED IN WHOLE OR PART TO ANYONE WITHOUT THE WRITTEN PERMISSION OF NEWNEX

COMPANY NAME**CUSTOMER SIGNATURE****DATE****COMMENTS:**

WIRING STRUCTURE			
Type C	SIGNAL NAME	A Male	
A4,B4,A9,B9	VBUS	1	
A5	CC	NC	
A7	Dn1	2	
A6	Dp1	3	
A1,B1,A12,B12	GND	4,7	
A3	SDPn1	5	
A2	SDPp1	6	
B10	SDPn2	8	
B11	SDPp2	9	
SHELL	Shield	SHELL	

Rp=56KΩ

Notes:

1. Cable: USB 3.1 Black PVC Jacket.
2. Connector: USB 3.1 A Male.
3. Connector: USB 3.1 Type-C Down Angled Male Dual-Screw Locking, with 56k Rp.
4. Packaging: 1 Piece + PE bag.

Newnex Technology Corp.

UNLESS OTHERWISE SPECIFIED
DIMENSIONS ARE IN MILLIMETERS
TOLERANCES ARE:FRACTIONS DECIMALS ANGLES
• NA X ± 0.5
XX ± 0.25
XXX ± 0.125

PROJ. SCALE: 1:1

REV. A

DATE: 7/16/2020

TITLE: USB 3.1 A Male to C Down Angle Male with Dual-screw Locking, 5M, Black.

DRAWN BY: XW

APPROVED BY:

PART NUMBER:

U3S1A01C6D-050

CHECKED BY:

SHEET 1 OF 1

REVISION COMMENTS:

Drawing generated

*100% OPEN, SHORT, MISWIRE TESTING

*RoHS compliant product

*Both shell clam and copper foil have 360 degree contact with braiding