

**NEWNEX PROPRIETARY**

THIS DOCUMENT AND THE DATA DISCLOSED HEREIN OR WITHIN IS NOT TO BE REPRODUCED, USED, OR DISCLOSED IN WHOLE OR PART TO ANYONE WITHOUT THE WRITTEN PERMISSION OF NEWNEX

**COMPANY NAME**

**CUSTOMER SIGNATURE**

**DATE**

**COMMENTS:**

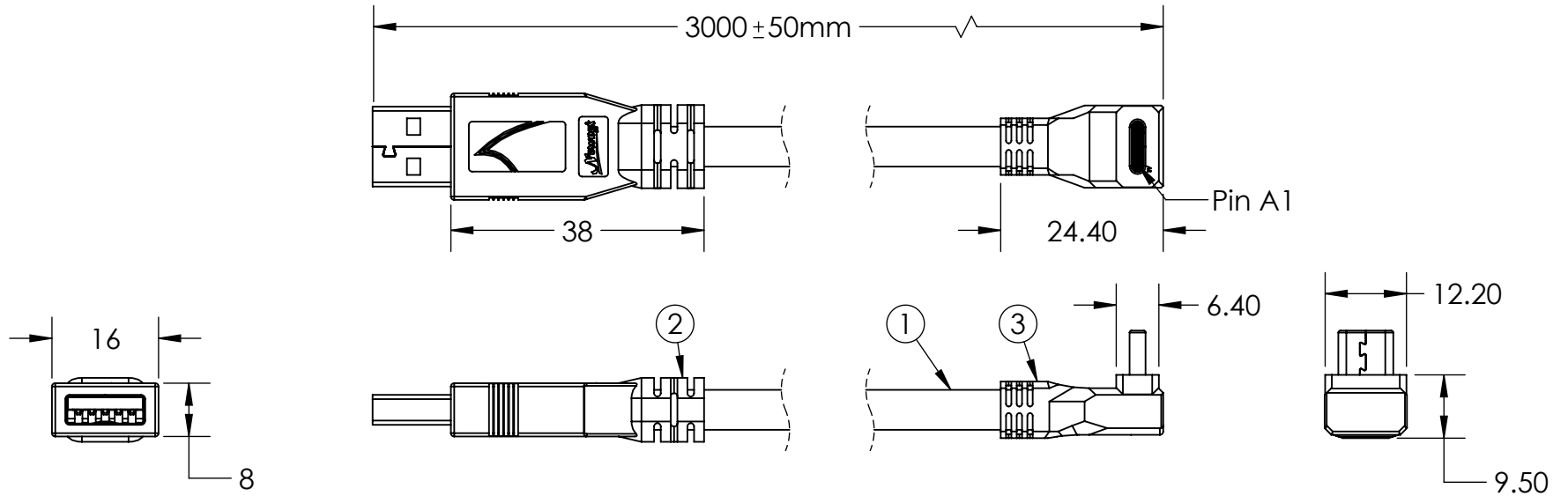

**WIRING STRUCTURE**

A Male	SIGNAL NAME	Type C
1	VBUS	A4,B4,A9,B9
-	CC	A5
2	Dn1	A7
3	Dp1	A6
4	GND	A1,B1,A12,B12 ,SHELL
7	Drain	
SHELL	Braid	
5	SDPn1	A3
6	SDPp1	A2
8	SDPn2	B10
9	SDPp2	B11

□ Rp=56K

**Notes:**

1. Cable: USB 3.2 Cable.
2. Connector: USB A Male.
3. Connector: USB Angled Type C Male
4. Packaging: 1 Piece + PE bag.

Newnex Technology Corp.



UNLESS OTHERWISE SPECIFIED DIMENSIONS ARE IN MILLIMETERS TOLERANCES ARE:

FRACTIONS DECIMALS ANGLES  
 # NA X ± 0.5  
 XX ± 0.25  
 XXX ± 0.125

PROJ: TITLE:

SCALE: 1:1 REV. A

DATE: 1/5/2026

TITLE: USB 3.2 A Male to Angled Type C Male ,3m, Black.

DRAWN BY: XW

APPROVED BY:

PART NUMBER: U3S1A01CV6-030

CHECKED BY:

SHEET 1 OF 1

REVISION COMMENTS: Drawing generated

\*100% OPEN, SHORT, MISWIRE TESTING

\*RoHS compliant product